

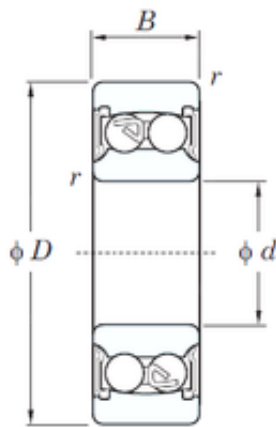

# BEARING-THAILAND CO.,LTD.

110 mm x 200 mm x 53 mm KOYO 2222-2RS self aligning ball bearings



Bearing No. 2222-2RS

Size	110x200x53 mm
Bore Diameter	110 mm
Outer Diameter	200 mm
Width	53 mm
d	110 mm
D	200 mm
B	53 mm
C	53 mm
r min.	2.1 mm
da min.	122 mm
da max	122 mm
Da max.	188 mm
ra max.	2 mm
Weight	7.10 Kg
Basic dynamic load rating (C)	80.2 kN
Basic static load rating (C0)	35.2 kN
(Grease) Lubrication Speed	1900 r/min
Calculation factor (e)	0.17
Calculation factor (Y0)	3.81
Calculation factor (Y1)	3.64

2222-2RS Bearing 2D drawings and 3D CAD models